

M101430

CLEANING WHIPPING MACHINE 2RV

Description:

Machine designed for removing residual hair and cleaning the animal's skin after the dehairing process and prior to entry into the singeing furnace.

This unit is structurally built with 6 mm thick stainless steel sheets forming two symmetrical welded bodies, providing high rigidity.

- Motors with shafts that gradually reach the entire surface of the carcass to ensure optimum finishing quality
- Motor-to-shaft transmission through a flexible coupling that increases motor lifespan
- Shaft weight is supported at the bottom by a tapered roller bearing support
- The shafts are fitted with 12 sets of stainless steel discs, each holding 16 flails fixed with 4 stainless steel carriage bolts. The design prevents metal wear on the shafts and allows easy flail replacement
- The structure facilitates drainage of water and debris to the bottom drip tray integrated into the processing line
- The two main bodies are joined by four hot-dip galvanized UPN portals, allowing easy integration into the overhead conveyor or carcass rail
- Includes a mid-height stainless steel bar to prevent carcasses from tangling in the shafts
- Upon request, inlet and outlet splash guards can be included to prevent water splashing outside the machine

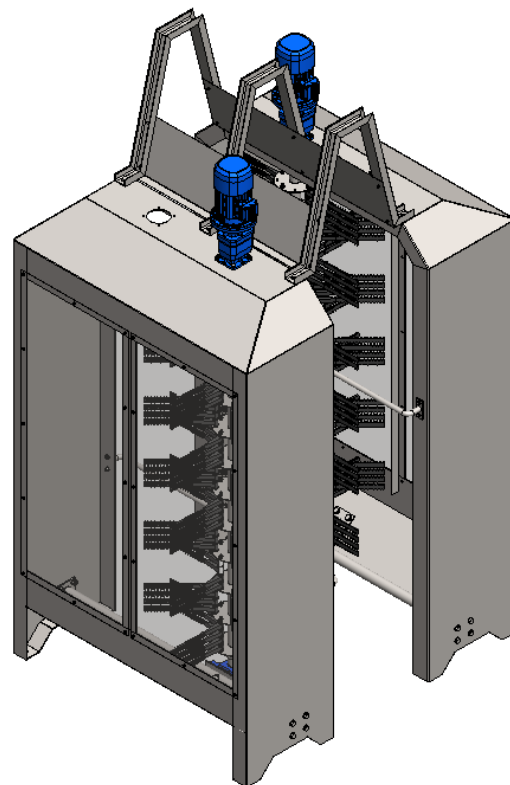

Mecanova incorporates rubber whipping, which significantly improves the quality of the carcass finish.

The equipment features a dual water diffusion system with low-consumption spray nozzles, installed in both machine bodies: two spray lines on top and two at mid-height to achieve thorough carcass cleaning.

An optional solenoid valve can be added to control the water flow, ensuring spraying only occurs when the overhead conveyor is operating.

It is recommended to connect the water supply to the cooling system of the singeing rail. This allows reuse of the cooling water, and if throughput is sufficiently high, the warm water helps maintain carcass temperature and remove any remaining hair.

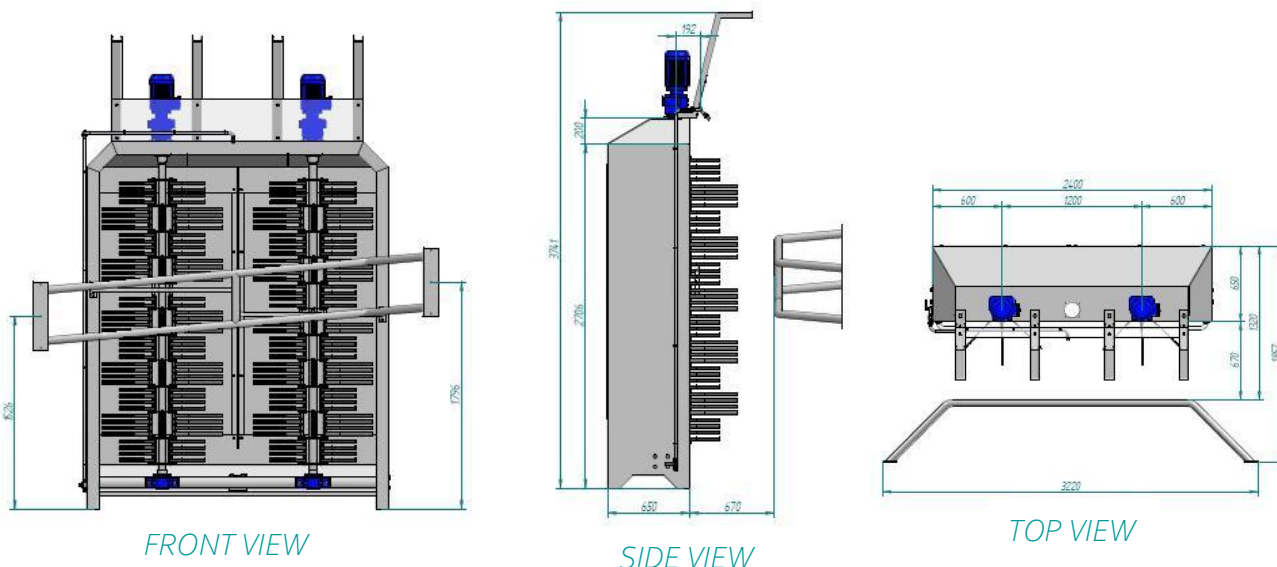

Technical Specifications:

- Constructed with a stainless steel AISI 304 frame and removable side panels made of stainless steel sheet
- Number of vertical rubber flail shafts: 2
- Length of each shaft: 2,300 mm
- Double rubber flails reinforced with bronze bushings on each flail
- Number of flails per shaft: 168
- Two gearmotors, each 3 kW
- Operating speed: 213 rpm
- Typical dimensions: 2,400 x 1,300 mm – Height: 3,740 mm
- Electrical control and operation panel not included
- Shower system with spray nozzles
- Water consumption: 733.2 litres/hour

DEMONSTRATION VIDEO

Documentation

The following documentation will be supplied with the machine:

- CE Warranty Certificate
- Operation and Maintenance Manual
- List of Recommended Spare Parts
- Drawings of Referenced Machine Components for the Maintenance Department
- Electrical and/or Hydraulic Schematics

